

# Easy to build air raid shelter

You will need...

Corrugated steel

Nuts and bolts

Hinges

Soil

A ladder

Your self

Spade

Fork

spanner

5 pieces of wood.

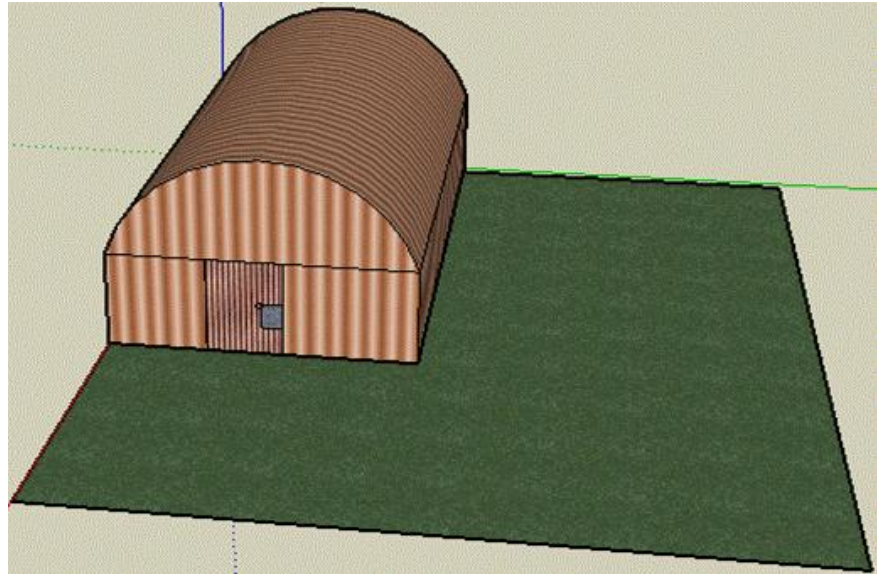

## Step 1

First use the spade to dig a twenty foot long, eleven feet wide & 3 feet deep trench.

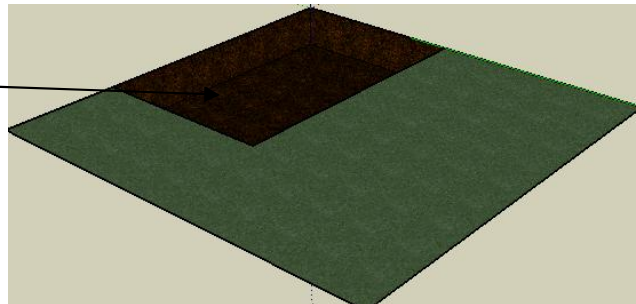

## Step 2

Then put some wood in the 4 corners of the hole.

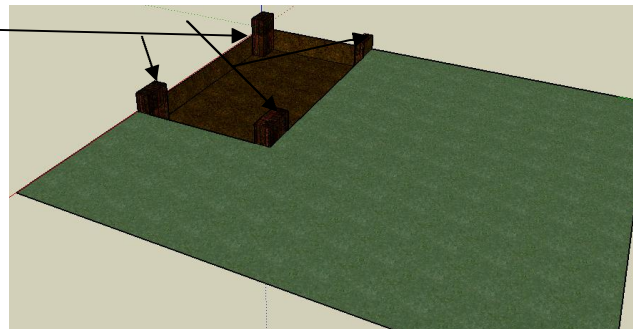

Step 3

Then put corrugated metal going from log to log.

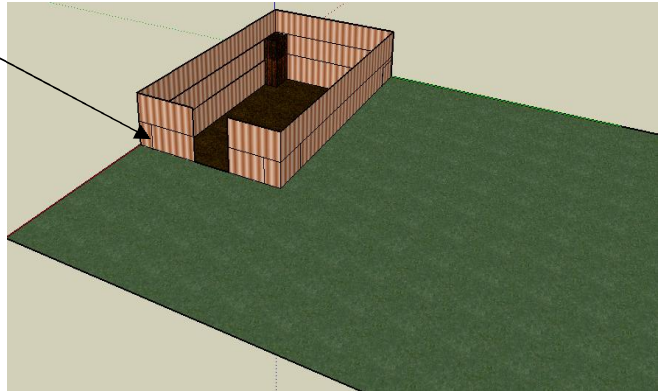

Step 4

Now put the door in.

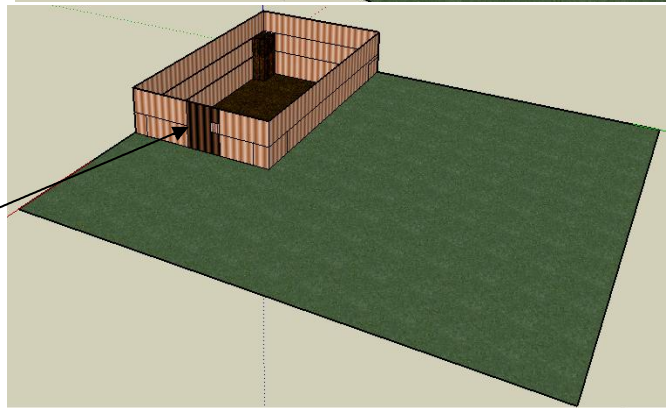

Step 5

Now put the floor in.

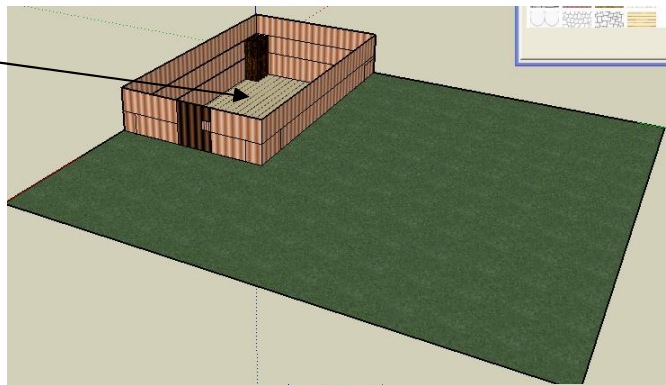

Step 6

Last of all, put the roof on.

